

FOOT OPERATED GREASE PUMP

INSTRUCTION MANUAL

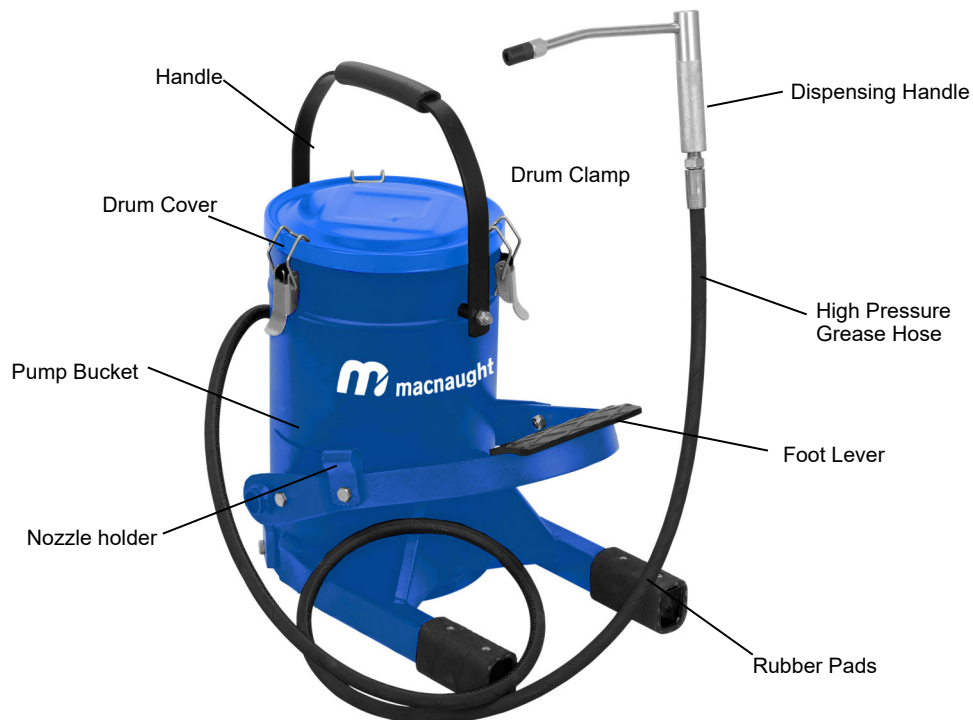



INTRODUCTION

The Macnaught high pressure portable grease Pump is designed for quick effortless greasing for most everyday greasing applications

With hand free operation, the pump operates using the foot lever, which provides high pressure greasing with highest comfort

Can be operated by hand when under low machinery

Designed with all moving parts submerged in the grease, thereby staying lubricated at all times.

The moving parts create a wave action in grease, automatically removing air pockets & eliminating the use of a follower plate

Suitable for use with NLGI 1 & 2 greases

Important Information

PLEASE READ THIS SAFETY INFORMATION CAREFULLY BEFORE USE.

Read and retain this instruction manual to assist you in the operation and maintenance of this product.

'CAUTIONS' are listed throughout this manual to advise of actions which may cause damage to your equipment.

Safety Information



CAUTION

- * Macnaught recommends the use of PPE equipment such as safety glasses, protective gloves, safety shoes etc before handling or using this product.
- * Continual use of this product can potentially cause RSI injury (especially hand or arm injury)
- * Do not modify or alter this product any way
- * Only physically fit people should be authorised to use this product
- * Ensure that any fluid spillage is cleaned up immediately to prevent slipping or injury.
- * Only use this product in a safe environment, away from heat, fire or explosive atmospheres etc
- * Ensure that the oil drum or container is always positioned on stable ground
- * Only use genuine Macnaught replacement parts when repairing this product
- * Never allow any part of the human body to come in direct contact with the fluid outlet.

OPERATION

The pump has a spring loaded wave action mechanism installed at the bottom of the bucket.

Pressing the foot lever makes the cylinder to move forward leaving empty space behind it. The grease due to its weight fills this empty space

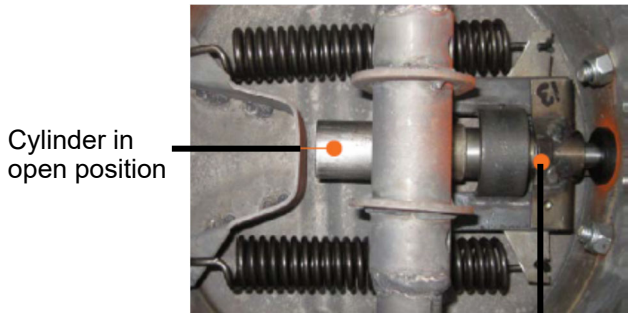

Spring loaded mechanism

On releasing the foot lever, the cylinder returns to its original position pushing the accumulated grease into a hollow piston that throws the grease from the pump outlet into delivery hose

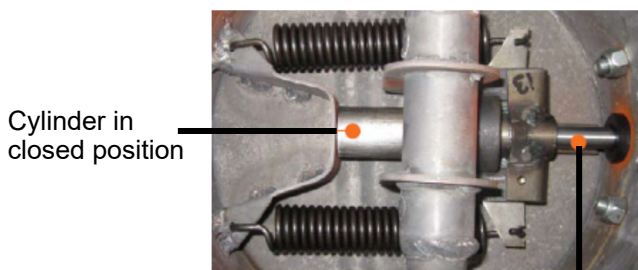

Hollow Piston

GREASE FILLING

When filling bucket with grease for the first time:

- 1) Ensure that grease is well settled well in bucket
- 2) Tap the bucket on the ground 5 to 6 times to allow the grease to settle the grease and remove air any pockets

Priming The Pump

The pump comes pre-primed from the factory. But when the pump is refilled, it may then require priming

To prime, press the foot pedal lever for 1-2 minutes until grease starts flowing through the coupler .

Always PRIME the pump when the pump is refilled with grease

Note: When working in cold weather or using a thicker grease, keep grease thin for easy workability in one of the following ways:

The user may need to warm grease in cold weather. NEVER overheat grease as it may lose its lubricating properties

* **Mix some oil (SAE30) with grease. Bump the bucket to remove any air pockets**

* **Heat grease bucket with a Barrel Warmer or Heating Jacket. The temperature should be kept at 0 - 30°C (32 - 86°F)**

OPERATION & USE

- 1) Fill recommended grease grade into the pump bucket
- 2) Tap the bucket on a firm surface to push the grease to displace air pockets trapped in the cavities in the base of the bucket
- 3) Operate the pump by pressing the foot lever a few times until grease comes out
- 4) Now the pump is ready for dispensing

PUMP DIAGRAM

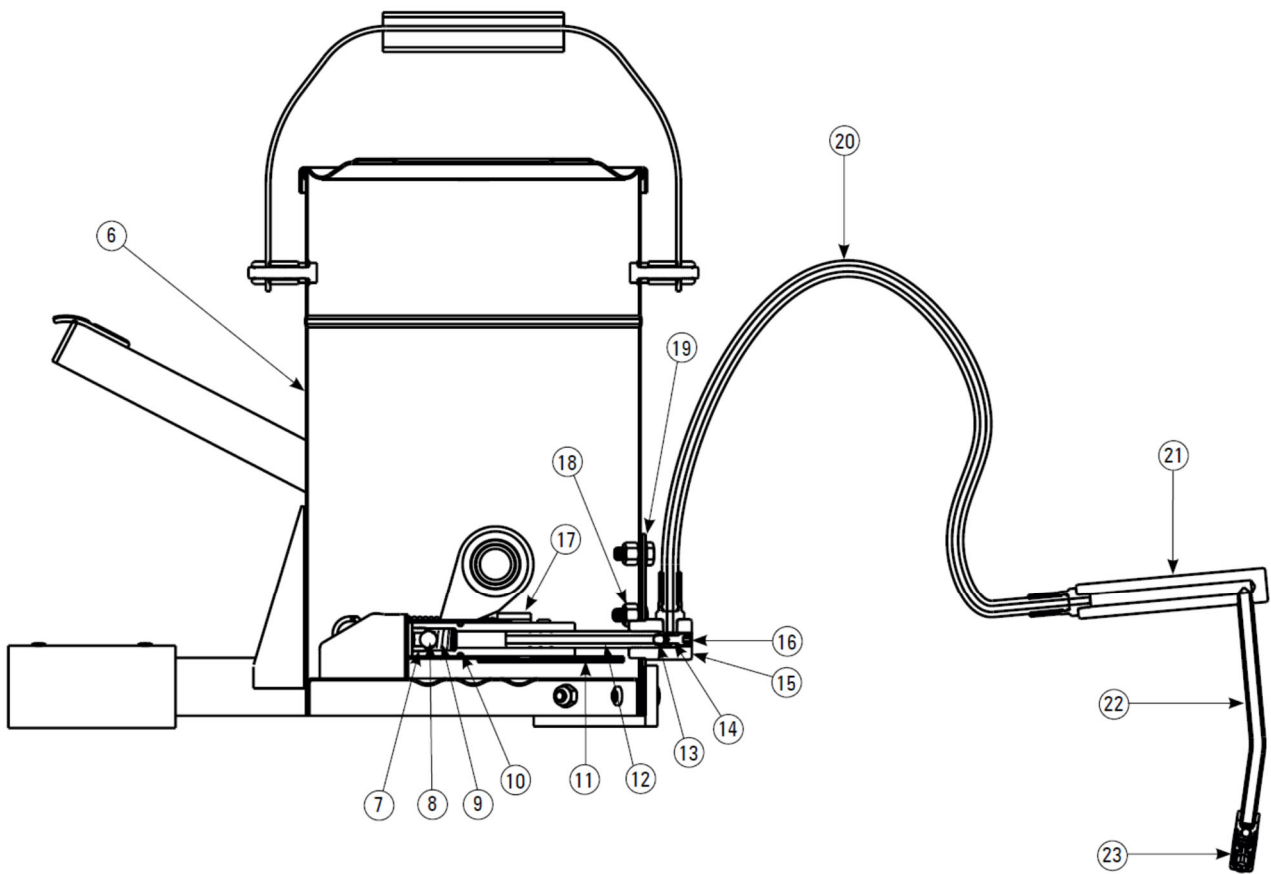
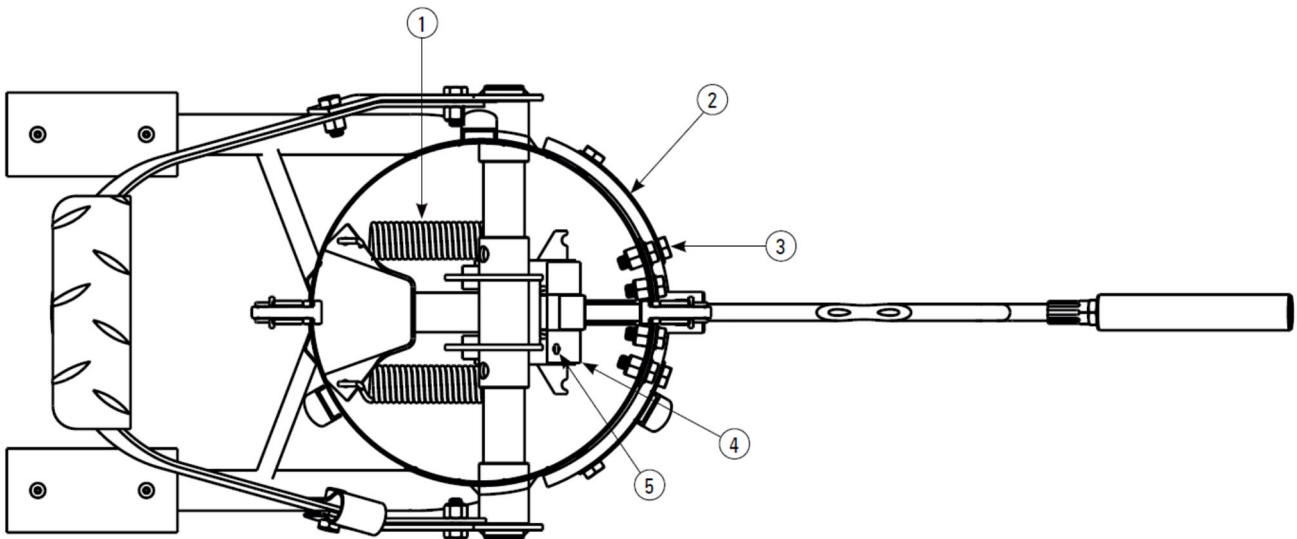

PART LIST

Ref No	Description	Qty
1	Extension spring	2
2	Rest pad	1
3	Bolt (8m x 1.25)	4
4	Plunger & bracket assembly	1
5	Cotter Pin	1
6	Bucket assembly	1
7	Non return body	1
8	Steel ball (7/16")	1
9	Plunger Spring	1
10	O'ring	1
11	Stopper	1
12	Piston	1
13	Steel ball (9/32")	1
14	Piston spring	1
15	Holder assembly	1
16	Grub screw	1
17	Pusher bracket	1
18	Nyloc nut	4
19	Rubber seal	1
20	Grease hose 1/4" ID	1
21	Hose handle	1
22	Grease bend pipe	1
23	Hydraulic coupler	1

AVAILABLE KITS

Main piston kit includes	Ref No
Extension spring	1
Plunger & Bracket assembly	4
Cotter Pin	5
Non Return body	7
Steel Ball (7/16")	8
Plunger Spring	9
O'Ring	10
Stopper	11
Piston	12
Steel Ball (9/32")	13
Piston Spring	14
Holder Assembly	15
Grub Screw	16
Pusher Bracket	17

Hose Assembly kit	Ref No
Grease Hose 1/4" I.D	20
Hose Handle	21
Grease Bend Pipe	22
Hydraulic Coupler	23

Kit Part Numbers

Pump Piston Kit - BPPK - 1K
 Hose Assembly Kit BPHAK - 1K (BSP)
 Hose Assembly Kit BPHAK - 2K (NPT)

TROUBLE SHOOTING

PROBLEM	CAUSE	SOLUTION
Pump dose not dispense grease	Air pockets trapped in grease	Refer to priming the pump
	Grease is too thick or cold (in winter)	Use NLGI 1 or 2 grease or warm grease with barrel warmer
	Damaged pump piston	Replace pump piston or contact service centre

SPECIFICATIONS

Pump Mechanism	Foot Operated
Pressure up to	8.700psi (600bar)
Delivery	2gms / stroke (1oz / 15 strokes)
Bucket Capacity	10kg (22lb)
Delivery Hose	1/4"x 2m
Grease Type	NLGI 1 & 2
Wetted Components	Steel, Nitrile Rubber

NOTES:



**macnaught**

Head Office - Australia
Macnaught Pty Limited
ABN 66 000 075 785

41-49 Henderson St
Turella, NSW, 2005
Sydney, Australia.

T: +61 2 9567 0401
F: +61 2 9597 7773
W: www.macnaught.com.au

Macnaught USA Inc
(North & South America)
614 South Ware Blvd. Tampa,
Florida, 33619 United States.

T: +1813 628 5506
F: +1813 628 5506
E: info@macnaught.com
W: www.macnaughtusa.com



Note:

This product should be disposed of according to all applicable local and national government environment regulations and guidelines.



For Warranty Terms and Conditions see macnaught.com.au
For a list of Australian Service Centres see macnaught.com.au